

TOPAZ COMPACT VALVE

PRODUCT INFO



[COMPACT]
FLOAT VALVE

Description

Topaz compact float valves are float operated valves for use in the automatic filling of water troughs, tanks & cisterns where space is limited. The valve is configured for above water mounting only. The compact weighted float operates a small pilot valve which in turn operates the main diaphragm valve. Topaz Compact float valves are positive on/off and are ideal when working with pump supplied water in a small compartment.

Applications

Maintaining Water Levels in:

- Animal Drinking Troughs
- Water Storage Tanks
- Water Cisterns
- Air Conditioning Systems
- High Pressure Cleaning Systems
- Irrigation Applications

Flow Graph

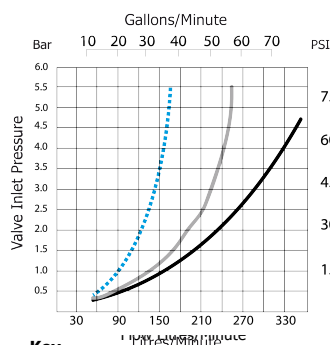

Key
 — 15mm (1/2")
 — 20mm (3/4")
 — 25mm & 32mm (1" & 1 1/4")

Features

- Compact Weighted Float
- High flow
- Compact robust construction
- Made from corrosion resistant materials
- Shuts down slowly to minimise water hammer
- 20 - 60mm (3/4" - 2 1/2") water level differential (increases as water inlet pressure increases)
- Pressure rating 0.3 - 10 Bar (5 - 150 PSI)
- Float position easily adjustable with no tools
- Valve has switch to lock it in off position
- Has port to connect Frostpro anti freeze device
- Detach™ Valve Seal Access System for quick access to valve seal

Mounting Positions

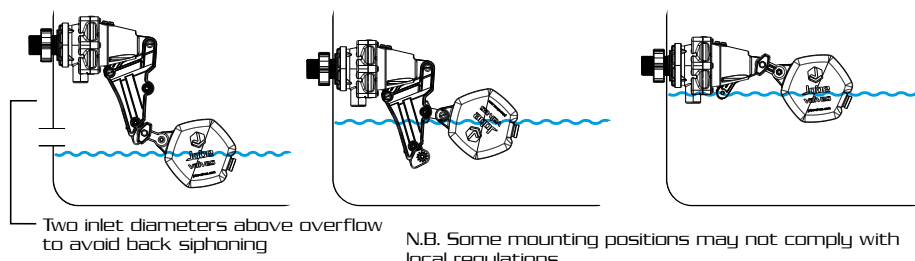

Options

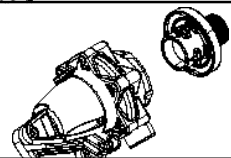
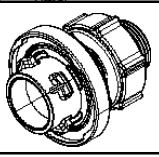
	BSP				NPT				 Thread size	
Inlet Size	1/2"	3/4"	1"	1 1/4"	1/2"	3/4"	1"	1 1/4"		
Detach Base Short Tail		✓	✓	✓		✓	✓	✓	 Detach	
Detach Base Long Tail	✓	✓	✓	✓	✓	✓	✓	✓		
Long Tail: Supplied with backnut and seal washer.										 Compact Float 55mm
Floats: 55mm wide float supplied standard. N.B. (No other float is compatible with this valve)										

TOPAZ TROUGH VALVE SPECIFICATION

PRODUCT	CODE	INLET SIZE	CODE	OPTIONS	CODE
Topaz Compact Float Valve	TPVC	1/2" bsp/npt	15	Detach Base	D
		3/4" bsp/npt	20	Long Tail Thread	LT
		1" bsp	25		
		1" npt	1		
		1 1/4" bsp	32		
		1 1/4" npt	114		

NOTE: If no options are specified the standard ones will be supplied

Note: Product may differ slightly from these specs due to ongoing product development.

TOPAZ COMPACT VALVE

DIMENSIONS & MATERIALS



Topaz Dimensions

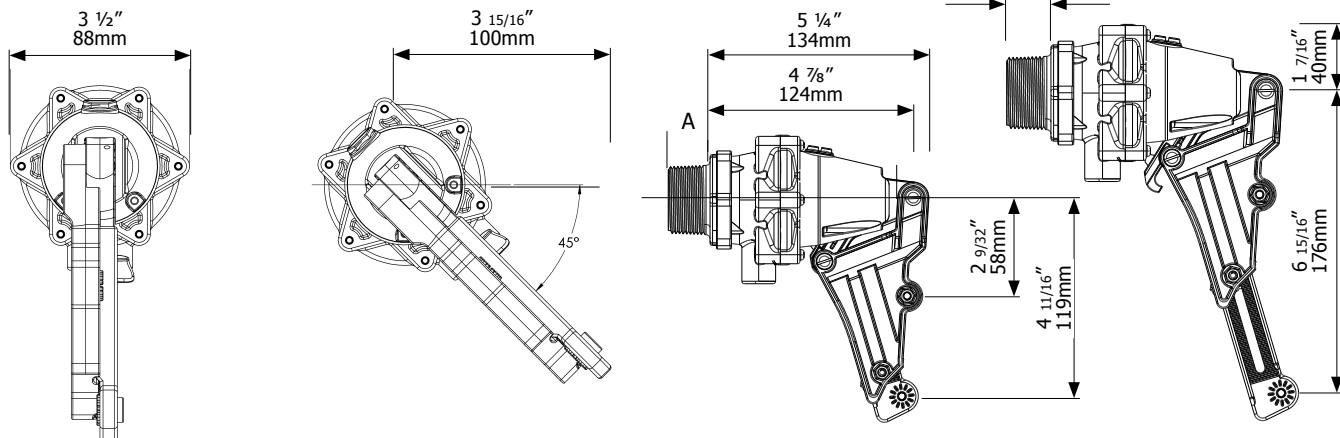

Float Dimensions

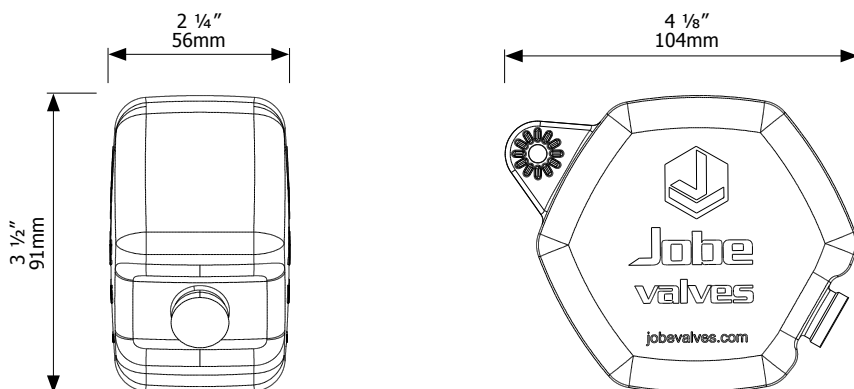

Tail Dimensions

Dimension A	mm	inches
20mm (3/4") Short tail	22	7/8
25mm (1") bsp/npt short tail	22	7/8
32mm (1 1/4") bsp/npt short tail	25	1
15mm (1/2") long tail	100	4
20mm (3/4") long tail	38	1 1/2
25mm (1") bsp/npt long tail	54	2 1/8
32mm (1 1/4") bsp/npt long tail	60	2 3/8

Part	Material	Part	Material
Valve Body & Tail	Glass Filled Nylon	Springs, Bolts, Nuts, Pin, Screws	304 Stainless Steel
White & Yellow Internal Parts	Acetal	O'Rings	Nitrile
Filter	PP/Nylon	Float	HDPE
Diaphragm	EPDM	Actuator / Arms & Caps	ABS
Seal	TPU		
Float Cord	Polyester		

Maximum Operating Temperature

60°C, 140°F

TOPAZ COMPACT FLOAT VALVE

PARTS IDENTIFICATION SHEET

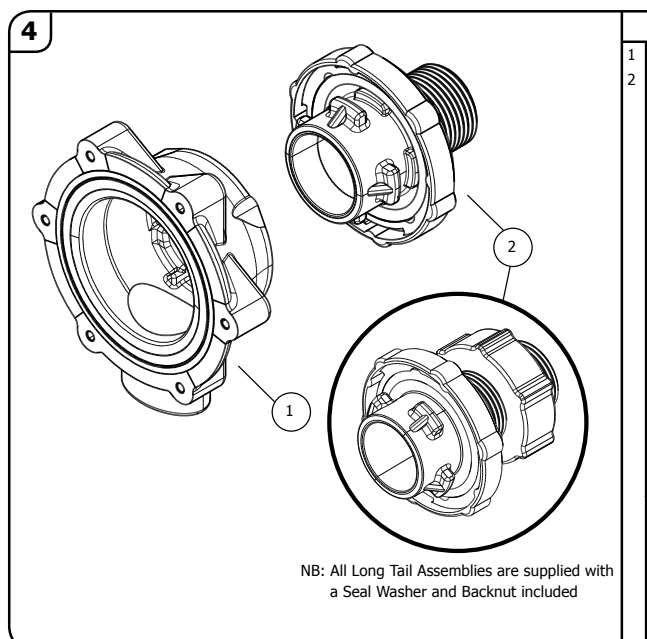
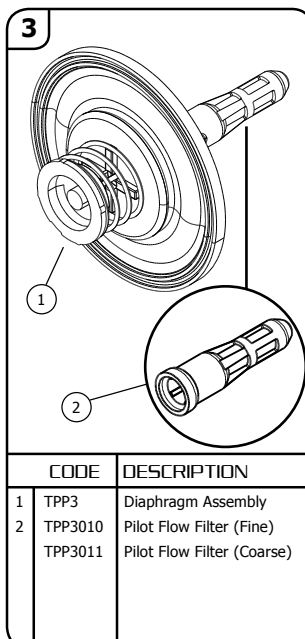
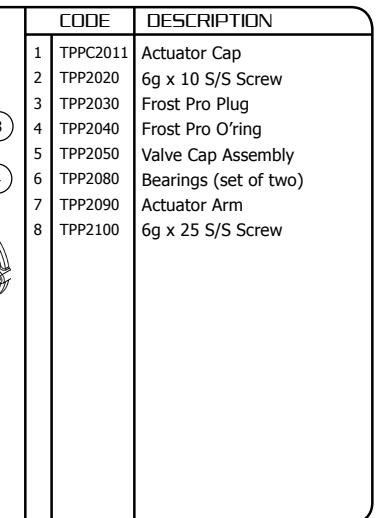
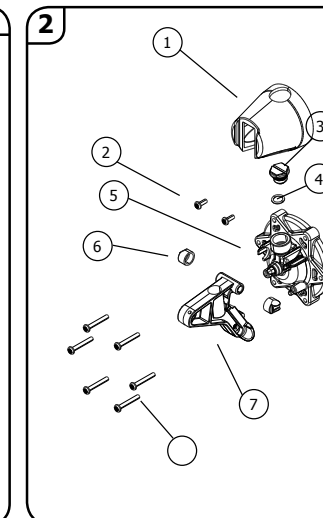
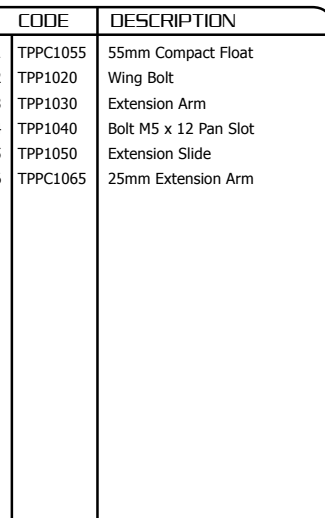
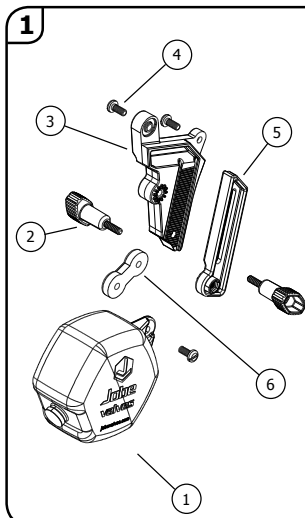
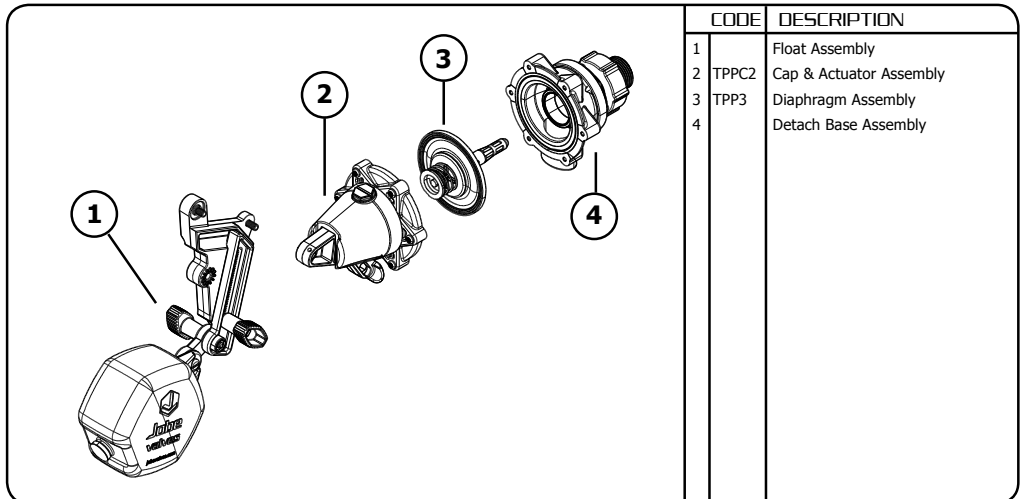
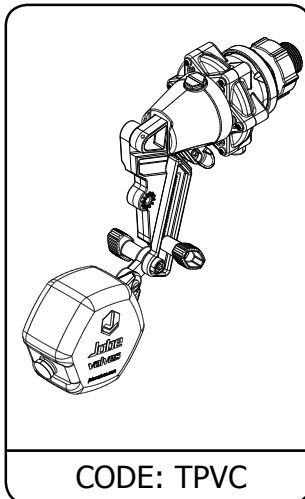

CODE	DESCRIPTION
1	DTP1 Detach Base
2	BSP Tails
	Short Tail Assembly (BSP)
DTP020	Detach Tail 20mm(3/4") Short
DTP025	Detach Tail 25mm(1") Short
DTP032	Detach Tail 32mm(1 1/4") Short
	Long Tail Assembly (BSP)
DTP015L	Detach Tail 15mm (1/2") Long
DTP020L	Detach Tail 20mm (3/4") Long
DTP025L	Detach Tail 25mm (1" bsp) Long
DTP032L	Detach Tail 32mm (1 1/4" bsp) Long
	NPT Tails
	Short Tail Assembly (NPT)
DTP0075	Detach Tail 3/4" npt
DTP0100	Detach Tail 1" npt
DTP0125	Detach Tail 1 1/4" npt
	Long Tail Assembly (NPT)
DTP0050L	Detach Tail 1/2" npt Long
DTP0075L	Detach Tail 3/4" npt Long
DTP0100L	Detach Tail 1" npt Long
DTP0125L	Detach Tail 1 1/4" npt Long